

SUITES 1100, 1115, 1120, 1150 & 1160

701B
701 B STREET
SAN DIEGO, CA 92101
Downtown

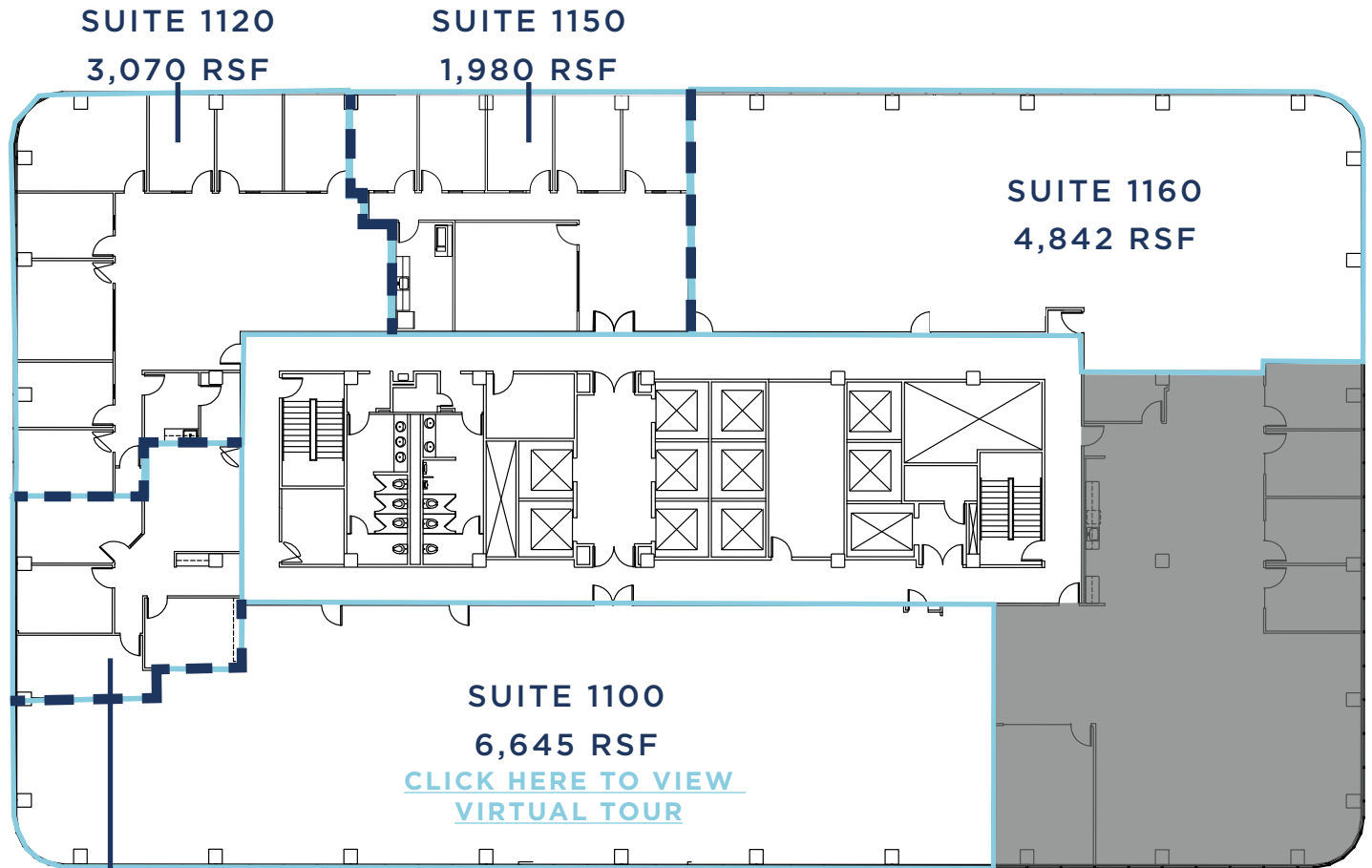

SUITE 1115
1,356 RSF

SUITE	1100	1115	1120	1150	1160
RSF	6,645	1,356	3,070	1,980	4,842
STATUS	Vacant	Vacant	2/1/2021	Vacant	Vacant
DESCRIPTION	Double-door entry. Shell condition. Expansive South-facing views.	Excellent West facing views. 4 offices (or 3 offices and conference room), reception and print/copy area.	Excellent West facing views. 7 offices, conference room, reception, open area, break room and IT room/storage.	Double-door entry, 5 window-lined offices, conference room, break room and small open office. Upgraded LED lighting and ceiling tiles.	Shell condition. Ready for custom tenant improvements.

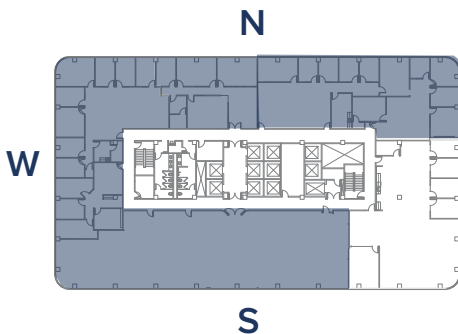

Suites 1100, 1115, 1120, 1150 & 1160 are contiguous to 17,893 RSF

For Leasing Information, Please Contact

Derek Hulse | +1 858 334 4005
derek.hulse@cushwake.com
Lic. #01740180

Philip Roberts | +1 858 558 5651
philip.roberts@cushwake.com
Lic. #01908296

Morgan Reno | +1 858 558 5603
morgan.reno@cushwake.com
Lic. #02030032

Owned & professionally managed by:

